

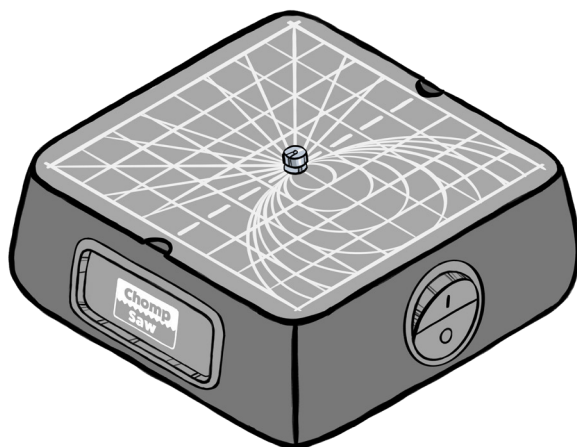

OPERATOR'S MANUAL

Model No.: SAW-001

ChompSaw



CAUTION: ELECTRIC TOY

Not recommended for children under 3 years of age.

As with all electric products, precautions should be observed during handling and use to prevent electric shock.

CAN ICES-3(B)/NMB-3(B)

SOR/2011-17



Read this ENTIRE MANUAL prior to using this product. Failure to follow the important safety instructions and warnings in this manual may result in serious injury.

LET'S GET MAKING!

To whom it may concern (that's you!),

Congratulations on your brand new ChompSaw!

We can't wait to see what you make, and we know you can't either. But before you get started, be sure to carefully read this entire manual to make sure you get the most out of your ChompSaw and stay safe while doing it.

This manual covers all the basics and even a few tips & tricks to get you on your way to creating cardboard inventions more impressive and imaginative than you ever thought possible (even if you already thought you could make pretty cool things).

As you continue making, we want to hear from you. There is no feedback more valuable than YOURS! Visit The ChompsShop online to tell us what you think or to discover more tips & tricks (or to let us in on a few of your own!).

THE
CHOMPSHOP
TEAM



www.chompsshop.com/translation

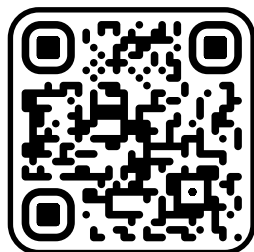

www.chompsshop.com

IMPORTANT SAFETY INFORMATION

This Operator's Manual contains important instructions, warnings, and safety procedures that must be understood **BEFORE** using the ChompSaw. Failure to review and understand the **ENTIRE MANUAL** prior to use could result in serious injury or product malfunction.

WARNING

OPERATIONAL SAFETY. Do not remove or adjust the cutting mat lid while the machine is running. This may result in severe injury

Do not leave the machine running unattended. Turn the tool off when not actively cutting.

Prevent unintentional starting by ensuring the switch is in the OFF position before connecting to the power source.

CHILD SAFETY. This tool is not recommended for use by children under 8 years of age. Ensure adult supervision at all times during use. Failure to follow these instructions could result in injury.

CALIFORNIA PROPOSITION 65.

WARNING: This product can expose you to chemicals, including Bisphenol A (BPA), which are known to the State of California to cause cancer, birth defects or other reproductive harm. For more information, go to www.P65Warnings.ca.gov.

CAUTION

CAUTION: To prevent electric shock do not immerse in water

ELECTRICAL SHOCK HAZARD. Misuse of the power supply can cause electrical shock. The ChompSaw shall only be used with a power supply for toys. The ChompSaw shall be used with the power supply supplied. The power supply is not a toy. The power supply used with the ChompSaw shall be regularly examined for damage to the supply cord, plug, enclosure, or other parts, and in the event of damage, it shall not be used until the damage has been repaired. Ensure the power adapter is properly matched to the outlet. Never modify the plug. Do not use adapter plugs. Never use the cord for carrying, pulling, or unplugging the ChompSaw. Keep cord away from heat, oil, sharp edges, or moving parts.

CAUTION: Very warm cutting head.

CUTTING ELEMENT SAFETY. Do not touch the cutting shaft or cutting head while in operation or immediately after use to avoid burns or injury.

MATERIAL USAGE. Do not force material through the cutting head if it is

- anything other than cardboard or other paper products.
- thicker than 3 millimeters.

Ensure the cutting material is suitable for this machine.

ELECTRICAL REQUIREMENTS

22 V  2.5 A DC only, 55 W (MAX)

PARENTS: Your ChompSaw should be periodically examined for potential hazards and that any potentially hazardous parts be repaired or replaced

WARNING: Changes or modifications not expressly approved by the party responsible for compliance could void the user's authority to operate the equipment.

NOTE: This equipment has been tested and found to comply with the limits for Class B digital device, pursuant to part 15 of the FCC rules. These limits are designed to provide reasonable protection against harmful interference in a residential installation. This equipment generates, uses and can radiate radio frequency energy and if not installed and used in accordance with the instructions, may cause harmful interference to radio or television reception, which can be determined by turning the equipment off and on. The user is encouraged to try to correct the interference by one or more of the following measures:

- Reorient or relocate the receiving antenna.
- Increase the separation between the equipment and the receiver.
- Connect the equipment into an outlet on a circuit different from that to which the receiver is connected.

Consult the dealer or an experienced radio/TV technician for help.

Supplier's Declaration of Conformity

47 CFR § 2.1077 Compliance Information

Unique Identifier

Trade Name: KaiZen Dynamic Limited

Model No.: SAW-001

Responsible Party - U.S. Contact Information

US Company Name: ChompsShop, Inc.

Address: PO BOX 880, Narberth PA 19072, USA

Telephone number or internet contact information: hello@chompsshop.com

FCC Compliance Statement

This device complies with Part 15 of the FCC Rules. Operation is subject to the following two conditions: (1) This device may not cause harmful interference, and (2) this device must accept any interference received, including interference that may cause undesired operation.

CHOMPSHOP MAKES NO WARRANTIES, EXPRESS OR IMPLIED, IN FACT OR IN LAW, INCLUDING, BUT NOT LIMITED TO, ANY IMPLIED WARRANTIES OF MERCHANTABILITY OR FITNESS FOR A PARTICULAR PURPOSE. To the extent that the applicable jurisdiction limits ChompsShop's ability to disclaim any implied warranties, this disclaimer shall be effective to the maximum extent permitted.

- (1) Cutting head
- (2) Cutting mat
- (3) Power switch
- (4) Dust collection drawer
- (5) LED status indicator
- (6) Vents
- (7) DC power port

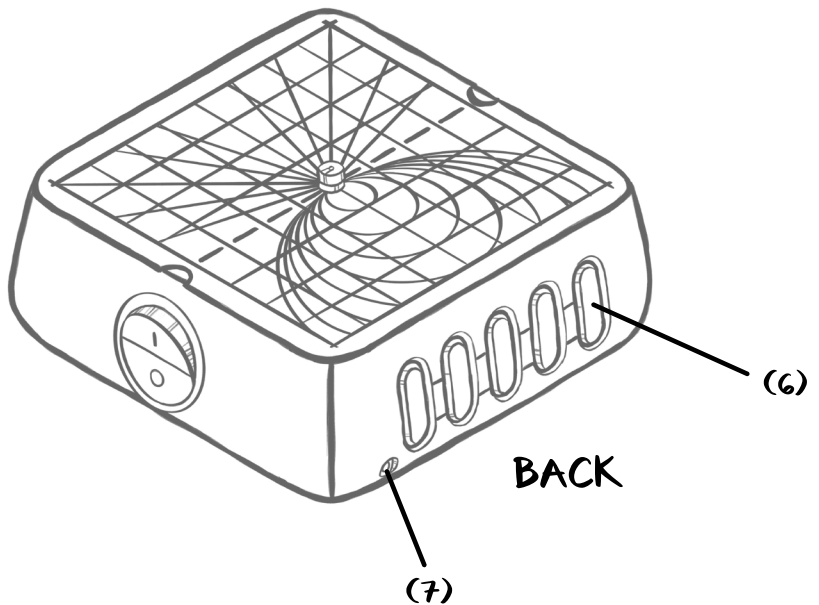
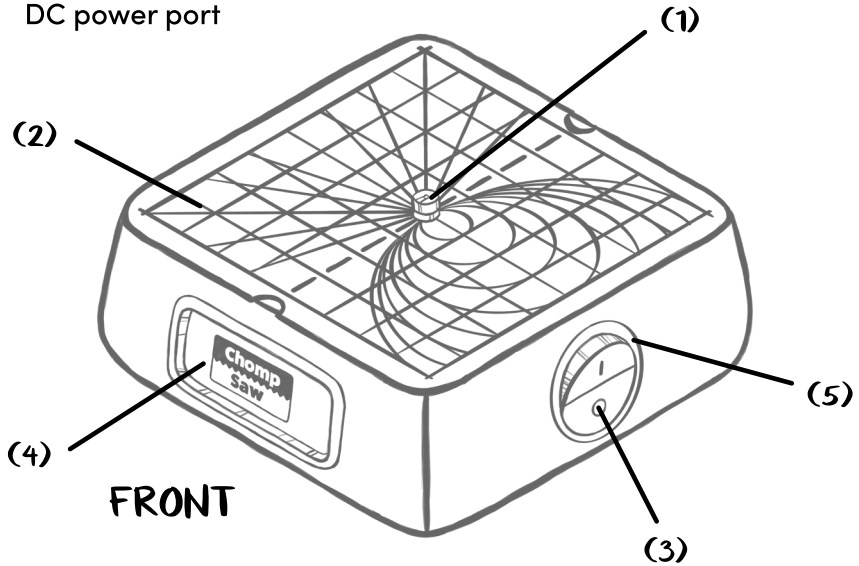

- (8) Cutting head gap
- (9) Power supply
(Input: 100-120V ~50/60HZ 1.5A MAX, Output: 22.0V 2.5A)
 - A. Prongs
 - B. DC jack
- (10) Dust collection drawer recess
- (11) Storage recess

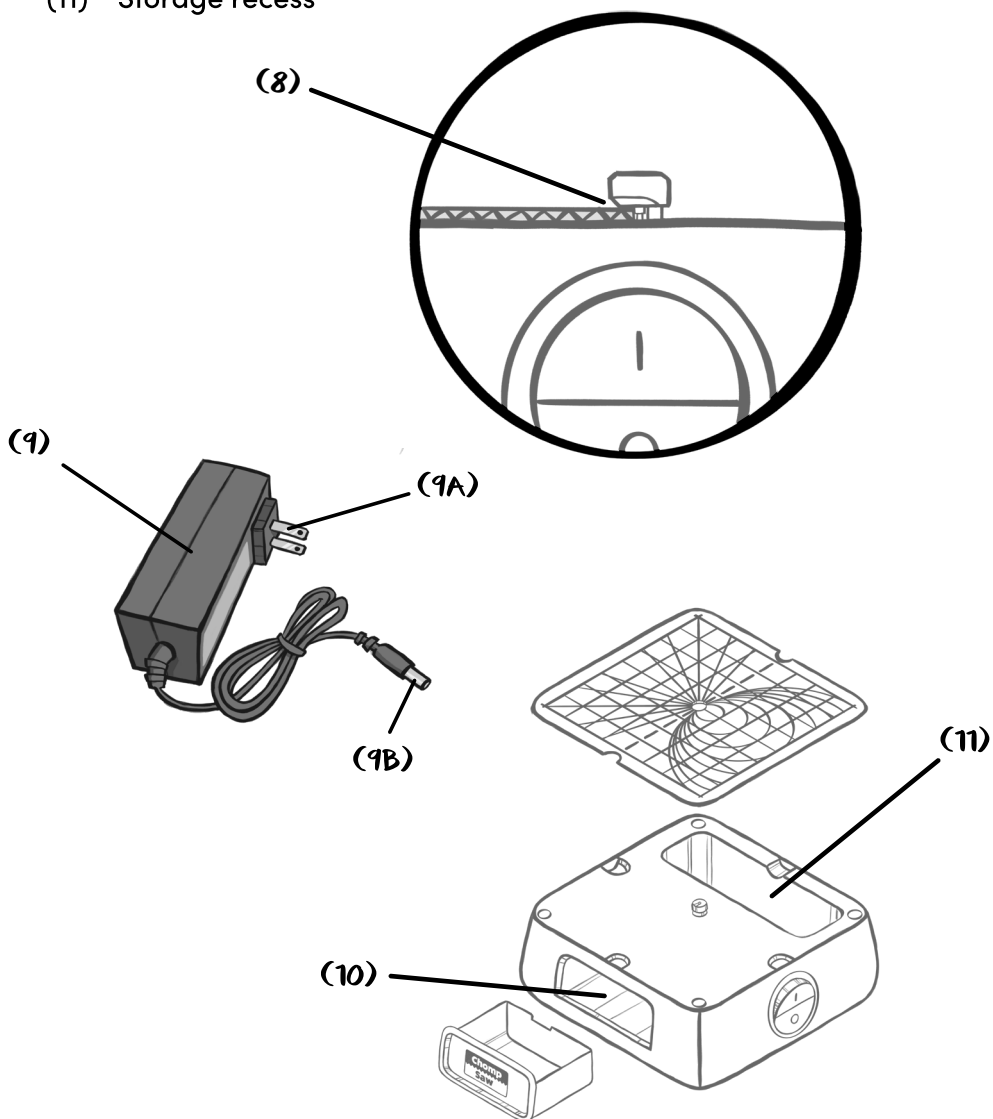

ASSEMBLY INSTRUCTIONS

SAFETY PRECAUTIONS

Before assembling the ChompSaw, please read and follow these safety precautions:

CAUTION: Do not use the ChompSaw if it is not fully assembled as per the instructions.

WARNING: Never attempt to modify or create accessories or attachments that are not recommended for use with this product.

ADULT SUPERVISION. It is strongly recommended that an adult supervise or assist in the assembly process, especially when children or individuals unfamiliar with the product are performing the assembly.

The power supply (9) may be stored underneath the cutting mat (2) in the storage recess (11).

1. The power supply prongs (9a) should be inserted into a wall outlet and the DC jack (9b) should be inserted into the DC power port on the ChompSaw (7).
2. The sheet metal cutting mat lid (2) should be placed so the arrows are pointing towards the back of the ChompSaw and all the lid text is legible when standing at the front of the ChompSaw. The lid may be flipped horizontally to view the grid in metric (MM) or imperial (IN) units (Fig. 4).
3. The dust collection drawer (4) should be inserted in the corresponding recess (10) so that the ChompSaw logo is right side up. The dust collection drawer must be fully inserted for the ChompSaw to operate. Refer to section "LED STATUS INDICATOR" to understand how the LED ring (5) can help diagnose this problem.

INSTRUCTIONS FOR USE:

1. Place the ChompSaw on a clean, flat surface and clear the immediate area of any obstructions.
2. Plug the included power supply (9) into the wall using the prongs (9a). Ensuring the power switch (3) is in the OFF position (Fig. 1), plug the DC jack (9b) into the DC power port on your ChompSaw (7).
3. Orient yourself so that the arrows on the lid are pointing away from you and the dust collection drawer (4) is facing you (this will place you at the front of the machine, see Fig. 2).
4. Press the power switch (3) to the ON position (Fig. 1). You should hear the ChompSaw turn on and see the cutting shaft moving inside the cutting head. Allow up to 10 seconds for the cutting shaft to reach full speed.
5. Lay your cardboard flat on the cutting mat between yourself and the cutting head, and push in the direction of the arrows (away from you), ensuring the cardboard is fed into the gap of the cutting head (8).
6. Continue pushing the cardboard away from you. To make curves and turns, rotate the cardboard and continue pushing away from you (Fig. 3). The ChompSaw will not cut if you push sideways.
7. When you have finished cutting, press the power switch to turn off the ChompSaw.
8. Check and empty the dust collection drawer (4) at least every 30 minutes to prevent overflowing cardboard clippings. Visit inventools.com to learn more about ways you can reuse or responsibly dispose of cardboard clippings beyond the trash can.

DO NOT leave the ChompSaw running when not in use. Turn off the ChompSaw between cuts to avoid wearing down the cutting elements or overheating.

TROUBLESHOOTING

Flipping the switch to the ON position but your ChompSaw is not turning on? Check the LED status indicator to diagnose your problem (see section “LED STATUS INDICATOR”).

Cardboard not cutting smoothly? Check the thickness of your material. Is it 3 MM or less? If you’re still having difficulty, you can compress cardboard along your planned cutting path using the blunt end of the scoring tool (sold separately).

LED STATUS INDICATOR

The LED status indicator (5) surrounds the power switch (3). You can determine the status of your ChompSaw and diagnose problems using the following table:

COLOR	PATTERN	STATUS	REMEDY
White	Solid	ON	N/A
White	Blinking	Drawer open OR ChompSaw not fully assembled	Ensure the drawer is fully inserted. If blinking persists, ensure the top and bottom housings are fully fastened together.
Red	Blinking	Overheating	Turn the device off for a cooldown period (minimum of 30 minutes). Do not operate the device during cooldown.
Red	Two blinks, pause, repeat	Fan malfunction	Contact Chompshop support. Do not attempt to operate the device.
Red	Solid	Motor stall	Contact Chompshop support. Do not attempt to operate the device.

TIPS & TRICKS

There is an optimal feed speed (the speed you push cardboard through the cutter). You may be tempted to push cardboard through the machine at maximum speed, but you'll get more precise cuts and have a better time if you find that sweet spot. It might be a little slower than you think. Try different speeds to find what works best for you and your ChompSaw.

The cutting head can get warm. The temperature will not exceed beyond safe levels, but if the cutting head begins feeling too warm for comfort you can quickly cool it down by removing the dust collection drawer and turning the machine on. The motor will be deactivated, but the fan will continue to run and quickly cool the cutting head.

There is a small white marking on the cutting head to help guide your cuts. If you are using a template or have drawn a pattern yourself, line your cutting lines up with the mark on the cutting head to best follow your lines.

For more tips on how to get the most out of your ChompSaw, follow this QR code or go to www.chompshop.com/learn

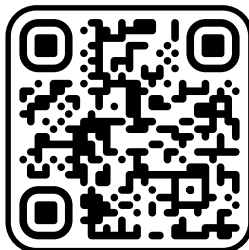
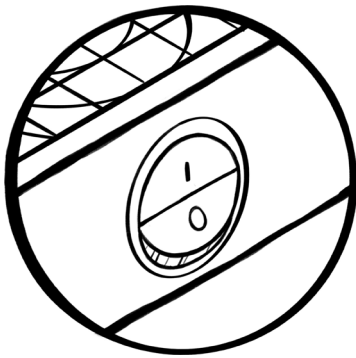
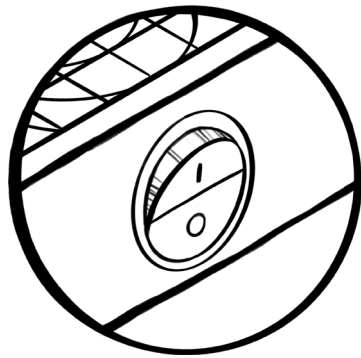

FIG 1



ON



OFF

FIG 2

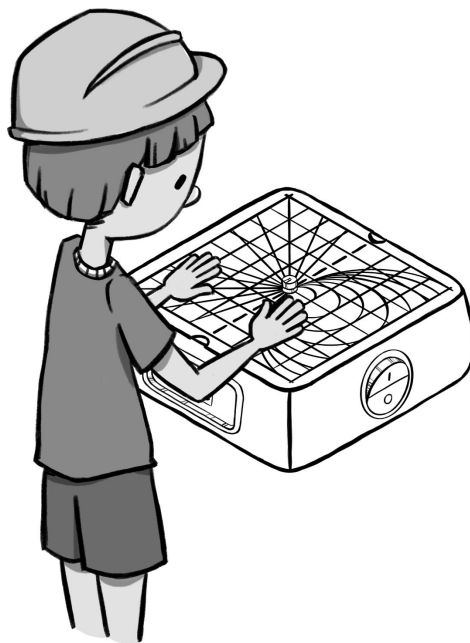

FIG 3

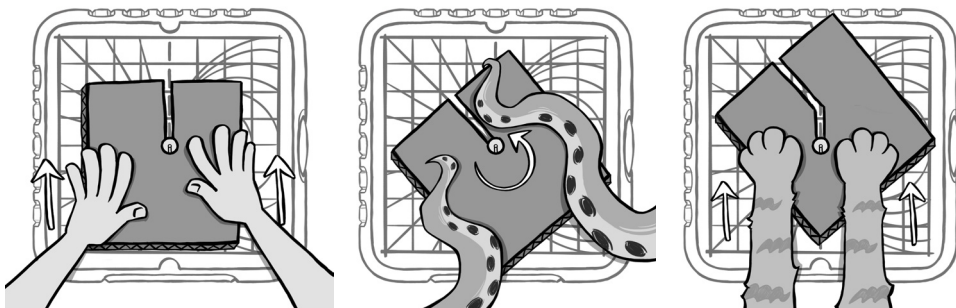
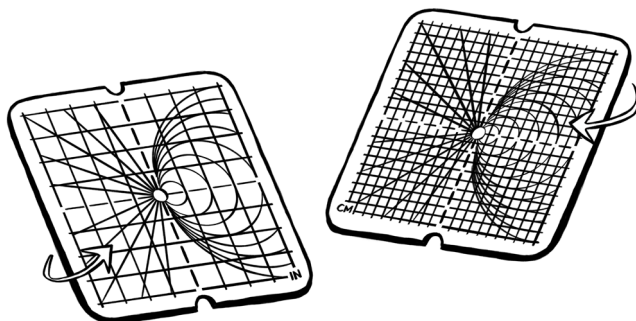

FIG 4



Chompshop

Copyright © 2025, by Chompshop, Inc., All rights reserved

144 N Narberth Ave, #880, Narberth, PA 19072, USA

hello@chompshop.com